

design **GIULIO CAPPELLINI** e **ROBERTO PALOMBA** 1999

5051CW02

Coprivaso avvolgente in termoindurente

5051CW03

Coprivaso avvolgente in termoindurente a discesa rallentata

Complementi: **Vaso Link (LK117)**
Vaso Link sospeso (5051/WC)
Vaso MiniLink sospeso (5064)
Vaso MiniLink con attacchi per Base (5064A)

Dim. Imballo 53 x 40 x 7 cm | Peso 3 kg | Pz. Pallet n° -

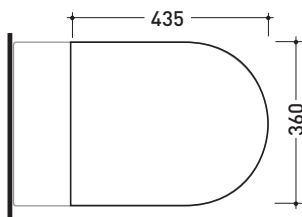

art. LK117
vista zenitale / zenital view

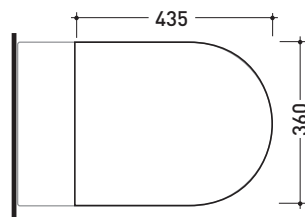

art. 5051/WC
vista zenitale / zenital view

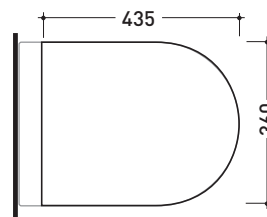

art. 5064
vista zenitale / zenital view

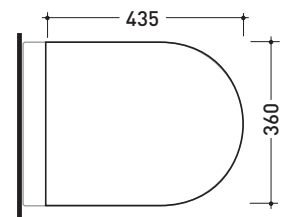

art. 5064A
vista zenitale / zenital view

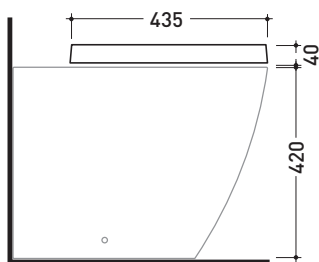

art. LK117
vista laterale / lateral view

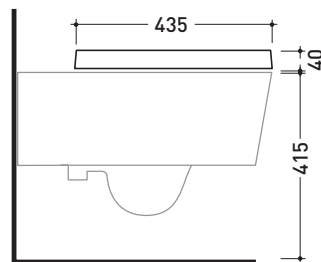

art. 5051/WC
vista laterale / lateral view

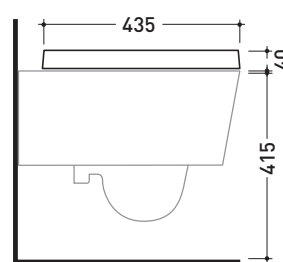

art. 5064
vista laterale / lateral view

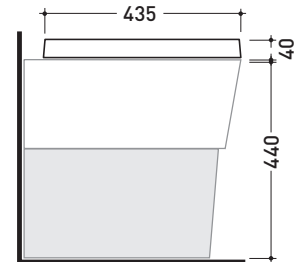

art. 5064A
vista laterale / lateral view

dimensioni in mm

gennaio 2014

TERMOINDURENTE: finiture lucide



TERMOINDURENTE: finiture opache

